

Std 5- NSTSE Test Paper

This Test Paper Contains 4 Sections.
Read every question carefully.

Mathematics(1-45)

1. A box had some pens in it. When the pens are distributed equally to 18 children, none remained but while distributing to 19 children, 5 children got 1 pen less than the others. How many pens were there in the box ?

- (A) 70 (B) 76 (C) 90 (D) 85

2. What must be added to $2\frac{2}{5}$ to give $3\frac{3}{10}$?

- (A) $\frac{9}{10}$ (B) $1\frac{1}{5}$ (C) $\frac{5}{6}$ (D) $5\frac{7}{10}$

3. What is the value of $14 + \frac{8}{10} + \frac{108}{100} + \frac{345}{100} + ?$

- (A) 16.225 (B) 15.262 (C) 16.252 (D) 16.255

4. PQRS is a trapezium.

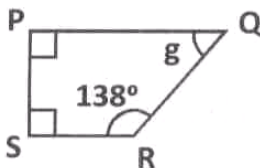

Find $\angle g$.

- (A) 42° (B) 48° (C) 62° (D) 69°

5. The average of X and Y is 108. Y is 300% the value of X. Find the difference between X and Y.

- (A) 108 (B) 54 (C) 36 (D) 144

6. The sides of a triangle are in the ratio 3 : 4 : 5. If the longest side is 15 cm, what is the perimeter of the triangle ?

- (A) 18cm (B) 48cm (C) 24cm (D) 36cm

7. What is the smallest possible 5-digit even number that can be formed using all the digits in the sum of 82349 and 8268 ?

- (A) 10769 (B) 16790 (C) 10796 (D) 19706

8. P is the least common multiple of 45 and 50.

What is the value of $10P + 100$?

- (A) 4500 (B) 4600 (C) 4400 (D) 1000

9. Suman had to multiply 14.36 by 23. Instead, he added the two numbers. What is the difference between his answer and the actual answer ?

- (A) 315.69 (B) 292 (C) 293.92 (D) 292.92

10. How many more of the basic shape shown are needed to fill the box up ?

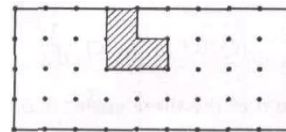

- (A) 11 (B) 9 (C) 10 (D) 12

11. If the length and breadth of a rectangle are doubled how does its perimeter change ?

- (A) Tripled (B) Doubled
(C) Halved (D) Remains the same

12. What is the missing digit in $3\Box 6013$ if

$$3\Box 6013 = 300000 + 70000 + 6000 + 10 + 3 ?$$

- (A) 3 (B) 6 (C) 1 (D) 7

13. How many times the H.C.F. of 11, 33 and 88 is their L.C.M. ?

- (A) 11 (B) 24 (C) 22 (D) 3629

14. What is the resultant of $0.3 \div 0.3 \times 3$?

- (A) $\frac{1}{3}$ (B) 0.3 (C) $\frac{1}{0.3}$ (D) 13

15. Find the sum of the three angles in a triangle.

- (A) 3 right angles (B) 4 right angles

- (C) 2 right angles (D) 270°

16. The given figure is made up of a triangle and a square of area 144 cm^2 .

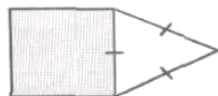

What is the perimeter of the figure?

- (A) 72cm (B) 60cm (C) 360cm (D) 12cm

17. What is the order in which numerical expressions are to be evaluated ?

- (A) M, A, S, D (B) D, S, M, A
(C) D, A, S, M (D) D, M, A, S

18. Identify the number whose prime factorization has three 2's, four 3's and a 5.

- (A) 3240 (B) 2430 (C) 3420 (D) 2304

19. Neev reads $\frac{3}{5}$ of a book. He has still 80

pages to be read to complete reading the book.

How many pages are there in the book ?

- (A) 200 (B) 100 (C) 400 (D) 300

20. Two numbers are respectively 20% and 50% more than the third number. What % is the first number of the second ?

- (A) 40% (B) 50% (C) 80% (D) 70%

21. Study the decimal numbers given in the box.

0.684	68.4	684	6.84
P	Q	R	S

Find the correct descending order of numbers.

- (A) P, Q, R, S (B) Q, R, P, S
(C) R, Q, S, P (D) R, Q, P, S

22. Which line segment joins the centre of a circle to a point on it ?

- (A) A diameter (B) A radius (C) A chord (D) An

23. Find the total volume of 4 exactly similar cubes of side 5cm.

- (A) 125cm^3 (B) 800cm^3 (C) 600cm^3 (D) 500cm^3

24. Identify the missing term in the equation.

$$909000 \div 9090 = 159 - \boxed{?}$$

- (A) 159 (B) 100 (C) 59 (D) 95

25. Which of the following are two consecutive prime numbers that differ by 2 ?

- (A) Co-primes (B) Twin primes
(C) Composite numbers (D) Both (A) and (B)

26. Study the decimal number line given.

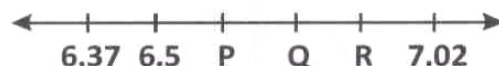

What is the value of $P + Q - R$?

- (A) 5.59 (B) 6.47 (C) 6.5 (D) 20.27

27. $\frac{2}{5}$ of a number is 48. What is $\frac{3}{5}$ of the same number ?

- (A) 50 (B) 72 (C) 56 (D) 78

28. A cycle travels at a speed of 45 km/h. How far will it travel in 36 minutes ?

- (A) 27 km (B) 20 km (C) 36 km (D) 45 km

29. Identify the numeral for "Six hundred one thousand and five hundred."

- (A) 600150 (B) 601500 (C) 601005 (D) 610500

30. The present time is 4 o'clock.



Through how many degrees will the hour hand move in 10 hours ?

- (A) 360° (B) 300° (C) 340° (D) 345°

31. 2 boys took a test. Pavan scored $\frac{4}{5}$ of what

Prateek had scored. If Pavan scored 76 marks, what was their total marks ?

- (A) 165 marks (B) 171 marks
(C) 181 marks (D) 190 marks
- 32. With which place does a 7-digit number start in the Indian system ?**
(A) Lakhs (B) Ten thousands
(C) Ten lakhs (D) Crores
- 33. What is the difference between 25% of 50 and 250% of 20?**
(A) 12.5 (B) 5 (C) 37.5 (D) 255.5
- 34. The L.C.M. of 3, 6 and x is 18. What is the possible value of x?**
(A) 36 (B) 6 (C) 18 (D) 3
- 35. Observe the given figure.**

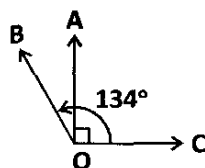

- What is the measure of $\angle AOB$?**
(A) 44° (B) 134° (C) 84° (D) 54°
- 36. What is the difference between the value of digit 5 and digit 7 ?**

453.07

- (A) 43 (B) 493 (C) 49.93 (D) 4993
- 37. Which fraction lies between $\frac{2}{5}$ and $\frac{5}{2}$?**
(A) $\frac{2}{5}$ (B) $\frac{7}{5}$ (C) $\frac{9}{2}$ (D) $\frac{7}{2}$
- 38. What is the average of all the multiples of ten from 10 to 190 inclusive ?**
(A) 90 (B) 95 (C) 100 (D) 105
- 39. Given that (p + 3) is the highest common factor of 81 and 108, find the value of p.**
(A) 6 (B) 12 (C) 9 (D) 24
- 40. What is the value of 23 weeks - 16 days ?**
(A) 7 weeks 6 days (B) 19 weeks 4 days
(C) 20 weeks 5 days (D) 21 weeks 4 days

- 41. The ratio of the heights of A and B is 4 : 3. If B is 1.2 m tall, find the height of A.**

(A) 0.9 m (B) 1.8 m (C) 1.6 m (D) 1.7 m

- 42. Which of the following is correct ?**

(A) $604 \text{ g} \times 100 = 60.4 \text{ kg}$ (B) $415 \text{ ml} \times 10 = 0.415 \text{ l}$

(C) $0.25 \text{ km} \times 100 = 250 \text{ m}$ (D) $1.12 \text{ l} \times 10 = 1120 \text{ ml}$

- 43. The figure consists of squares with equal size.**

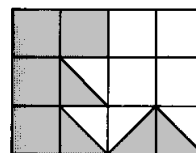

What is the percentage of the shaded parts ?

(A) 20% (B) 30% (C) 50% (D) 60%

- 44. What must be written in the box ?**

$$4\frac{1}{5} + \square = 9\frac{3}{10}$$

(A) $5\frac{1}{10}$ (B) $5\frac{2}{5}$ (C) $5\frac{1}{5}$ (D) $5\frac{1}{2}$

- 45. Which of the following is true ?**

(A) $9.801 \times 100 = 9801$ (B) $5.243 \times 10 = 524.3$

(C) $96.4 \times 1000 = 9640$ (D) $28.474 \times 100 = 2847.4$

General Science

- 46. This seed is best dispersed by**

(A) water. (B) birds (C) insects. (D) wind.

- 47. Which of the following animals and its respiratory organs is paired correctly ?**

	Adaptation	Function
(i)	Parrot	lungs
(ii)	Fish	gills
(iii)	Earthworm	ski
(iv)	Cockroach	gills

- (A) Only (i) and (ii) (B) Only (ii) and (iii)
(C) Only (i) and (iv) (D) Only (i), (ii) and (iii)

48. I protect the heart and the lungs I have curved bones which are fused firmly together.
What am I ?

(A) Skull (B) Ribcage (C) Spine (D) Sternum

49. To which class of lever is the fishing rod belong to

(A) Class (i) lever (B) Class (ii) lever
(C) Class (iii) lever (D) Inclined plane

50. In which process is carbon dioxide released ?

(i) Burning (ii) Respiration (iii) Photosynthesis

(A) Only (i) and (ii) (B) Only (ii) and (iii)
(C) Only (i) and (iii) (D) (i), (ii) and (iii)

51. Disha took out a cup of ice cream from the refrigerator and left it on a table for few hours. She then put the cup back into the refrigerator. After some time which of the following changes did the icecream undergo ?

(A) Solid → liquid → gas
(B) Solid → liquid → solid
(C) Solid → gas → solid
(D) Liquid → solid → liquid

52. What makes a flag raising up a flagpole much easier ?

(A) Inclined plane (B) Pulley (C) Lever (D) Fulcrum

53. Cactus and Camel have special adaptations to live in

(A) rain forest. (B) polar. (C) desert. (D) ocean.

54. The natural satellite of the earth is

(A) the sun. (B) the moon. (C) meteor. (D) astroid.

55. Which of the following actions involve a consumer and producer in a food chain ?

(A) A frog feeding on an insect
(B) A rabbit eating a carrot
(C) A boy consuming milk
(D) A cat feeding on a mouse

56. Use the picture below to answer question.

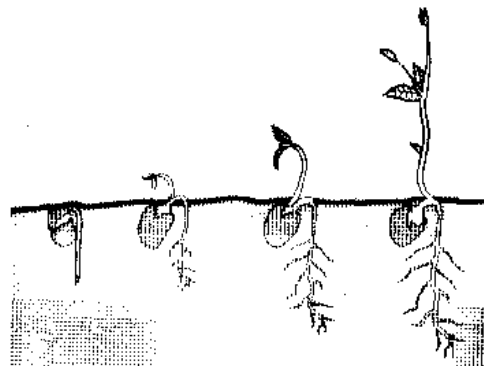

Sarika wrapped some bean seeds in a wet paper towel. She drew and labelled pictures of the bean seeds as they germinated. Which statement best matches Sarika's drawings ?

(A) Bean seeds grow smaller each day as they germinate
(B) Early stems and leaves come out before early roots
(C) Early stems and leaves grow up and early roots grow down
(D) The shoot contains early roots, stems, and leaves.

57. In the water cycle, condensation is the process of

(A) Water vapour cooling down and turning into a liquid.
(B) Ice warming up and turning into a liquid
(C) Liquid cooling down and turning into ice
(D) Liquid warming up and turning into water vapour

58. Akshat met with an accident and had a fracture. Which of the following clearly gives the fracture details to the doctor ?

(A) Blood report (B) An X-ray
(C) Muscle test (D) Urine report

59. The box given below contains the characteristics of a seed.

Light in weight, small and dry

Which of the following dispersal agents helps these seeds in their dispersal ?

- (A) Water (B) Wind
(C) Explosive mechanism (D) Animals

60. Look at the classification table below carefully.

Joint	
X	Y
Elbow, Knee	Shoulder, Pelvis

What do 'X' and 'Y' represent ?

- (A) X-Pivot joint, Y-Hinge joint
(B) X-Hinge joint, Y-Ball and socket joint
(C) X-Ball and socket joint, Y-Pivot joint
(D) X-Hinge joint, Y-Gliding joint

61. Typhoid, malaria and chicken pox are

- (A) communicable diseases.
(B) deficiency diseases. (C) genetic diseases.
(D) non-communicable diseases.

62. Accidents happen because of

- (A) carelessness of others. (B) our carelessness.
(C) hurry. (D) all of these

63. Identify X, Y and Z.

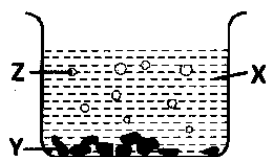

- (A) X-gas, Y-solid, Z-liquid
(B) X-liquid, Y-solid, Z-gas
(C) X-gas, Y-liquid, Z-solid
(D) X-solid, Y-liquid, Z-gas

64. In which box in this table would you place insects?

	Has legs	Has no legs
Has bones	P	Q
Has no bones	R	S

- (A) P (B) R (C) Q (D) S

65. You were given some plants or twigs of plants like brinjal, wheat, neem, banana and china rose. From them you were asked to select two plants, one which is a herb having tap root and leaves showing reticulate venation and the other herb with leaves showing parallel venation and fibrous roots, which two plants would you select for the same ?

- (A) Brinjal, wheat (B) Neem, maize
(C) Wheat, maize (D) Brinjal, neem

66. Which of these breathes in the same manner as the animal given below ?



Prawn

- (A) A mosquito pupa (B) A tadpole
(C) A frog (D) A seal

67. Which of the following is a rabi crop ?

- (A) Rice (B) Millets (C) Maize (D) Beans

68. The figure shows an animal.

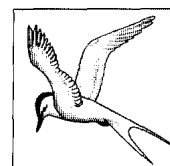

How does the animal protect itself from extreme weather conditions ?

- (A) It undergoes hibernation.
(B) It has a very thick cover of feathers.
(C) It migrates to warmer places.
(D) It has folded skin.

69. Lava cools to form

- (A) igneous rocks. (B) sedimentary rocks.
(C) metamorphic rocks. (D) sandstones.

70. What is the chemical formula of water ?

- (A) H₂O (B) HO₂ (C) 2HO (D) H₂O₂

71. Your immune system helps to protect you against viruses and bacteria that can cause

sickness. Which cells are part of the immune system?

- (A) White blood cells (B) Red blood cells
(C) Nerve cells (D) None of these

72. A boy kicks a football, it rolls for some distance and then stops on its own. This is due to

- (A) it does not want to move further.
(B) it has more air.
(C) friction force, which opposes the movement of ball.
(D) it bursts in the way.

73. Miles, metres, light years are used to measure

- (A) weight (B) length (C) distance (D) quantity.

74. Which of the following is a unit of mass in the metric system ?

- (A) Millimetre (B) Centimetre (C) Gram (D) Litre

75. Arrange these as first, second and third class levers ?

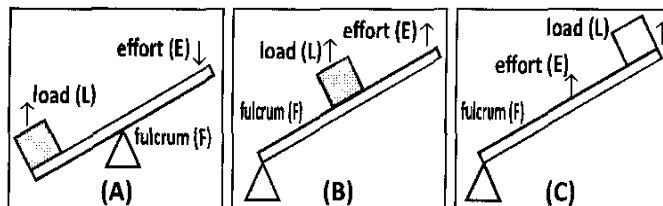

- (A) A, B, C (B) B, A, C (C) C, B, A (D) C, A, B

76. Observe the organisms below.

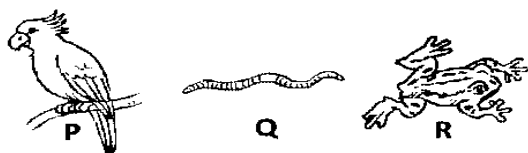

Which of these animals breathe through moist skin ?

- (A) Only P and Q (B) Only P and R
(C) Only Q and R (D) P, Q and R

77. What enables us to swing our arms as shown in the picture ?



- (A) Ball and socket joint (B) Pivot joint
(C) Hinge joint (D) sliding joint

78. Which gas in the air is represented by Part A ?

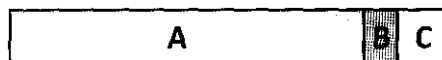

- (A) Nitrogen (B) Oxygen
(C) Carbon dioxide (D) Water vapour

79. How many types of levers are there ?

- (A) 4 (B) 2 (C) 3 (D) 1

80. When a stone is thrown upwards into the air, it comes down after some time because of

- (A) electrical force. (B) frictional force.
(C) magnetic force. (D) gravitational force.

81. In which of the rock types can fossil be found ?

- (A) Igneous (B) Sedimentary
(C) Metamorphic (D) Plutonic

82. Heat, light and electricity are all forms of

- (A) Atoms (B) Energy (C) Cells (D) Motion

83. A producer is a living thing that makes its own food from sunlight. Which of the following is a producer ?

- (A) A mango tree (B) A woman
(C) A Cow (D) Fungi

84. With respect to brightness which of the following is ranked third in the solar system ?

- (A) Mercury (B) Saturn (C) Venus (D) Earth

85. The given diagram is a TS of a flower. Which one among the following is correct labelling ?

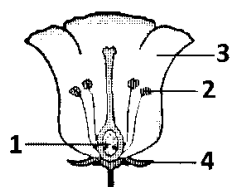

- (A) 1. Sepal 2. Petal 3. Ovary 4. Stamen
 (B) 1. Ovary 2. Stamen 3. Petal 4. Sepal
 (C) 1. Petal 2. Sepal 3. Ovary 4. Stamen
 (D) 1. Stamen 2. Ovary 3. Petal 4. Sepal

86. The diagrams below show a bird and a bat.

In what way are the two animals similar ?

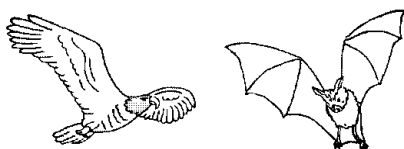

- (A) They both have wings. (B) They both lay eggs.
 (C) They both have beaks
 (D) They both have feathers.

87. Look at the figure given below.



It has few predators because of its

- (A) big feet. (B) small eyes.
 (C) hard shell. (D) large mouth.

88. Which of the following types of food should be consumed to reduce the risk of scurvy ?

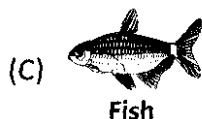

89. Which of the statements is/are correct ?

- (A) The moon has its own light.
 (B) The moon reflects the light of the sun.
 (C) The Moon reflects the light of the earth.
 (D) All the above

90. A ramp is

- (A) a lever. (B) a wedge.
 (C) an inclined plane. (D) a screw.

91. What type of creature is "Black Beauty" ?

- (A) A pig (B) A whale (C) A horse (D) A cow

92. What word completes the following idiom - "Once in a blue ____" ?

- (A) sky (B) water (C) moon (D) bird

93. Who among following is the founder of the Apple inc. ?

- (A) Steve jobs (B) Bill gates
 (C) Alan turning (D) Mark Dening

94. 'Manfred the Mammoth', 'Sid the Sloth' and 'Diego the Sabre-toothed Tiger' all appear in which film ?

- (A) Ice Age (B) Dinosaur
 (C) Evolution (D) Madagascar

95. In Karate, the highest degree is Black Belt. What is the beginning level ?

- (A) Yellow Belt (B) White Belt
 (C) Green Belt (D) Blue Belt

96. MC Marycom is the world champion in which of the following sports ?

- (A) Wrestling (B) Boxing
 (C) Swimming (D) Athletics

97. What is the name of this clownfish searching for his son called Nemo in Pixar film?



- (A) Marlin (B) Dory
 (C) Sheldon (D) Andy

98. 'Amar Shonar Bangia' is the title of the National Anthem of which country ?

- (A) China (B) Sri lanka (C) Bangladesh (D) Romania

99. What is the full form of ICC ?

- (A) Indian cricket committee
 (B) International cricket council
 (C) Indian cricket council

(D) International cricket committee

100. What is the speciality of a "Chameleon" ?

(A) It can live without food.

(B) It has no eyes.

(C) It changes color.

(D) It can breathe under water and fly.



Answer Key

1. C	2. A	3. A	4. A	5. A	6. D	7. C	8. B	9. D	10. A
11. B	12. D	13. B	14. D	15. C	16. B	17. D	18. A	19. A	20. C
21. C	22. B	23. D	24. C	25. B	26. C	27. B	28. A	29. B	30. B
31. B	32. C	33. C	34. C	35. A	36. C	37. B	38. C	39. D	40. C
41. C	42. A	43. C	44. A	45. D	46. D	47. D	48. B	49. C	50. A
51. B	52. B	53. C	54. B	55. B	56. C	57. A	58. B	59. B	60. B
61. A	62. D	63. B	64. B	65. A	66. B	67. D	68. C	69. A	70. A
71. A	72. C	73. B,C	74. C	75. A	76. C	77. A	78. A	79. C	80. D
81. B	82. B	83. A	84. C	85. B	86. A	87. C	88. B	89. B	90. C
91. C	92. C	93. A	94. A	95. B	96. B	97. A	98. C	99. B	100. C